

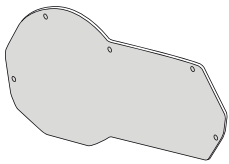

BMW
R1200GS LC / ADVENTURE LC / R1250GS / R1250GS ADVENTURE

REF 20814 **PROTECTOR DE FARO - HEADLIGHT PROTECTOR - SCHEINWERFERSCHUTZ**

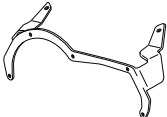
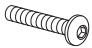

ID	PIEZA/PART	DESCRIPCIÓN	DESCRIPTION	QTY	REF
1		Protector faro (policarbonato con tratamiento antirayadas de 4mm)	Headlight Protector (polycarbonate 4mm with scratch resistance treatment)	1	20814WM3
2		Soporte metálico	Metal support	1	SOPOR-1P-6-7567
3		Tornillo Allen M5X20 Ø11 ISO7380	M5X20 Ø11 Allen screw	2	TORNIAI7380-387
4		Tornillo ISO 7380 M4x10 (negro)	M4x10 ISO7380 allen screw	5	TORNI-I7380-645
5		Arandela de nylon M4	M4 nylon washer	10	ARNV00000000311
6		Tornillo Allen M5X16 Ø11 ISO7380	M5X16 Ø11 ISO7380 Allen screw	2	TORNI-I7380-493

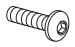
BMW R1200GS LC / ADVENTURE LC / R1250GS / R1250GS ADVENTURE

INSTRUCCIONES DE MONTAJE - MOUNTING INSTRUCTIONS - MONTAGEANLEITUNG

1

DISASSEMBLY
MONTAJE

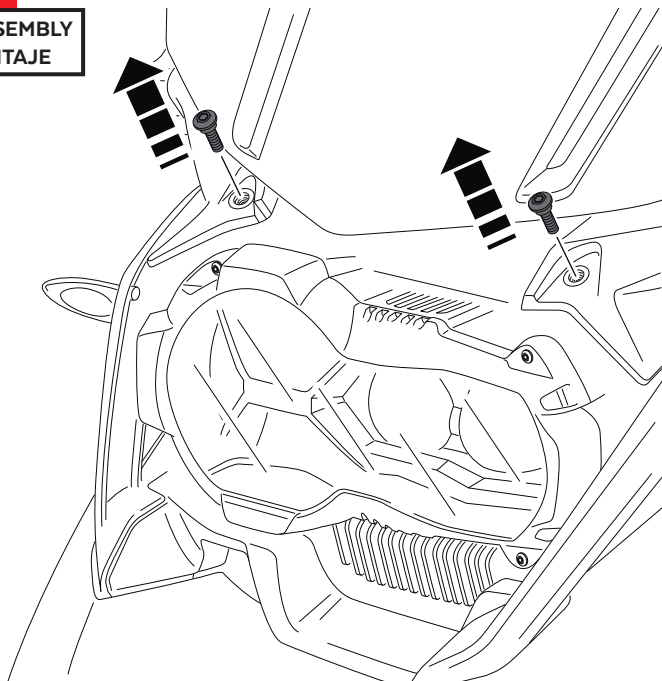

2

ASSEMBLY
MONTAJE

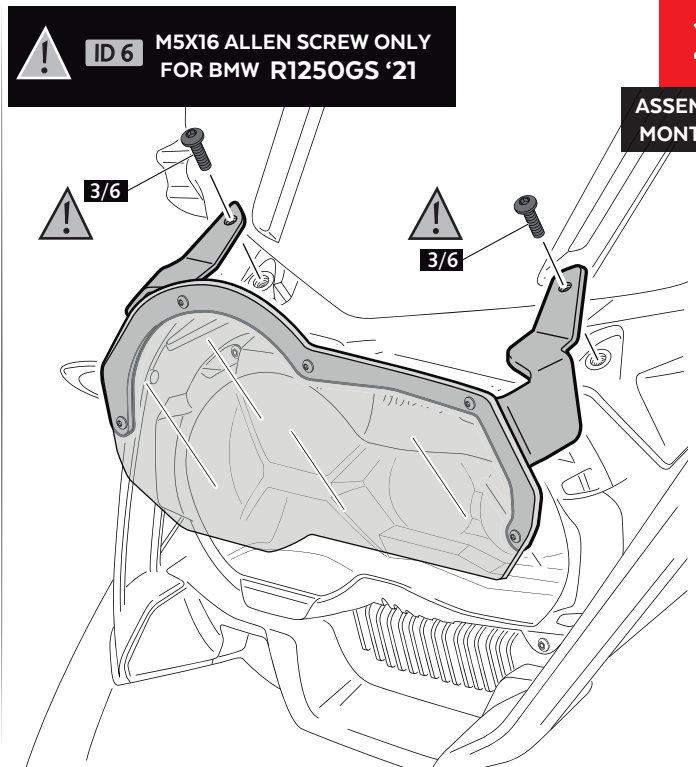

3

ASSEMBLY
MONTAJE

ID 6 M5X16 ALLEN SCREW ONLY FOR BMW R1250GS '21

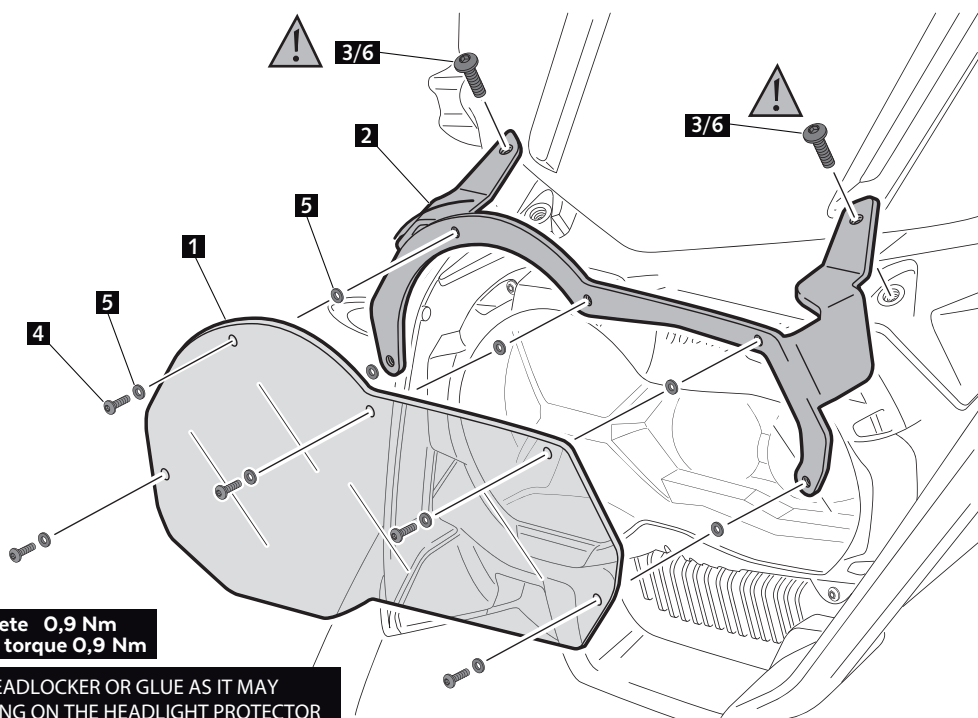

ID-4 Par de apriete 0,9 Nm
Tightening torque 0,9 Nm

ID-4 DO NOT USE THREADLOCKER OR GLUE AS IT MAY
PRODUCE CRACKING ON THE HEADLIGHT PROTECTOR