

KAWASAKI ZX-6R 636 '19-

M O U N T I N G I N S T R U C T I O N S

VIDEO

REF 3176

SIDE SPOILER DOWNFORCE



ID	PIEZA/PART	DESCRIPCIÓN	DESCRIPTION	QTY	REF
1		Base alerón derecha	Right main plain spoiler	1	10683
2		Winglet negro/azul/rojo/naranja/verde derecho	Right black/blue/red/orange/green Winglet	1	3692N/A/R/T/V
3		Base alerón izquierda	Left main plain spoiler	1	10683
4		Winglet negro/azul/rojo/naranja/verde izquierdo	Left black/blue/red/orange/green Winglet	1	3692N/A/R/T/V
5		Soporte metálico derecho	Right metal suport	1	SOPOR2P9-R-3176
6		Soporte metálico izquierdo	Left metal suport	1	SOPOR2P9-L-3176
7		Tuerca autoblocante M4	M4 Locking nut	4	TUERCAE985-0290
8		Arandela de goma Ø4,5 x Ø11 x 2mm	Ø4,5 x Ø11 x 2mm Rubber washer	4	ARAND-EPDM--722
9		Arandela de nylon M4x0,5	M4x0,5 Nylon washer	8	ARNV00000000311
10		Tornillo Allen M4x12 Ø9 ISO 7380	M4x12 Ø9 ISO 7380 Allen screw	4	TORNI-I7380-800
11		Tuerca de clip M5	M5 clip nut	2	TUERCA-TRT-M5--
12		Tornillo Allen M5x30 Ø9 ISO 7380	M5x30 Ø9 ISO 7380 Allen screw	2	TORNI-I7380-767
13		Casquillo Ø14 x Ø8 x 18	Ø14 x Ø8 x 18 Arrowhead	2	CASQUI-----0139
14		Tapón tornillo Allen M5 ISO 7380	M5 ISO 7380 Allen screw cap	4	TAPON-----85
15		Tornillo Allen M5x11 Ø11 ISO 7380	M5x11 Ø11 ISO 7380 Allen screw	4	TORNI-AI----520
16		Arandela de nylon M5x1	M5x1 Nylon washer	4	ARNV00000000245
17		Cinta adhesiva de doble cara 30x10mm (se suministra montada)	30x10mm double-sided adhesive tape (supplied assembled)	4	ADHESI-----263

KAWASAKI ZX-6R 636 '19-

INSTRUCCIONES DE MONTAJE - MOUNTING INSTRUCTIONS - MONTAGEANLEITUNG

1

DISASSEMBLY
DESMONTAJE

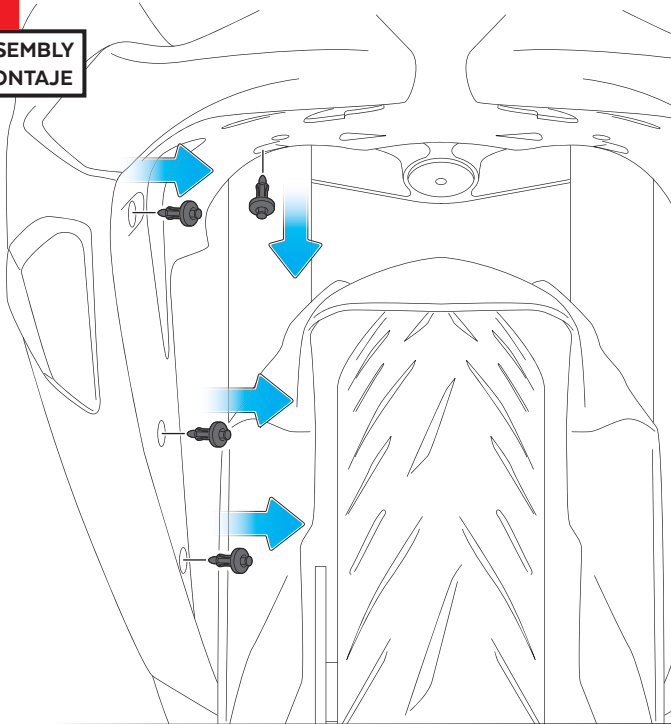

Se muestra el montaje del lado derecho a modo de ejemplo, realizar los mismos pasos para el montaje del lado izquierdo.
The right side assembly is shown as an example, so the same steps can be performed for the left side assembly.

2

ASSEMBLY
MONTAJE

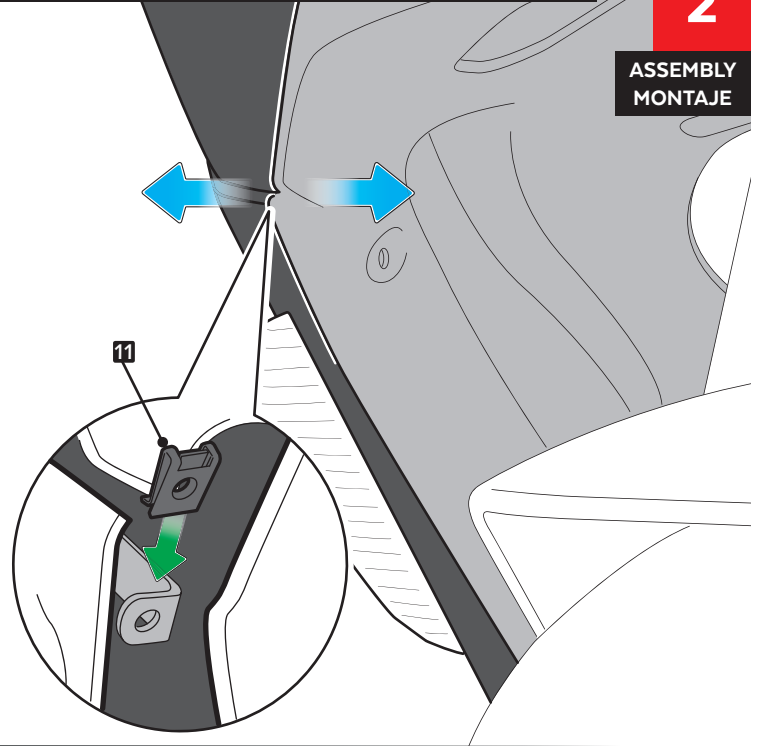

3

ASSEMBLY
MONTAJE

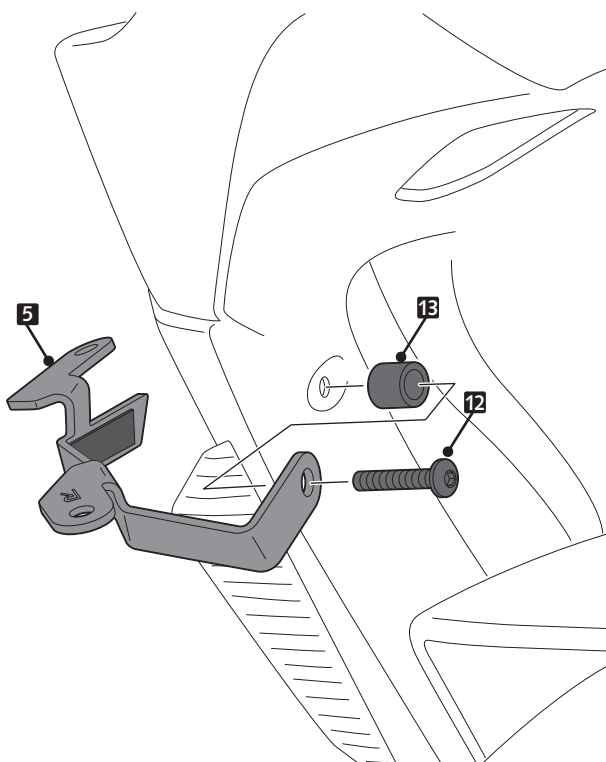

4

ASSEMBLY
MONTAJE

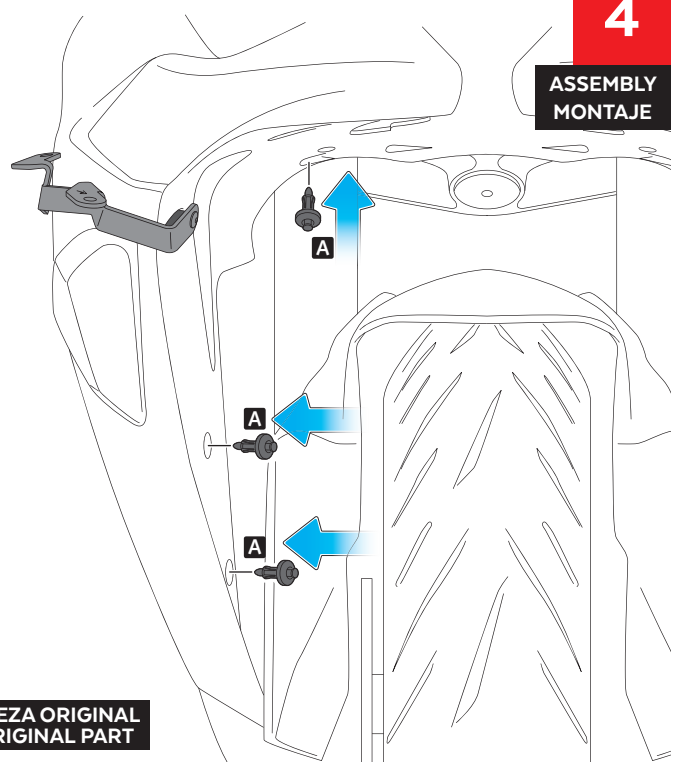

A PIEZA ORIGINAL
ORIGINAL PART

KAWASAKI ZX-6R 636 '19-

INSTRUCCIONES DE MONTAJE - MOUNTING INSTRUCTIONS - MONTAGEANLEITUNG

5

ASSEMBLY
MONTAJE

APPLY PRESSURE ON ADHESIVE AREA FOR 1 MINUT.
IDEAL TAPE APPLICATION IS ACCOMPLISHED WHEN
TEMPERATURE IS BETWEEN 21 °C and 38 °C AND THE
BOND IS ALLOWED TO DWELL 24 HOURS.

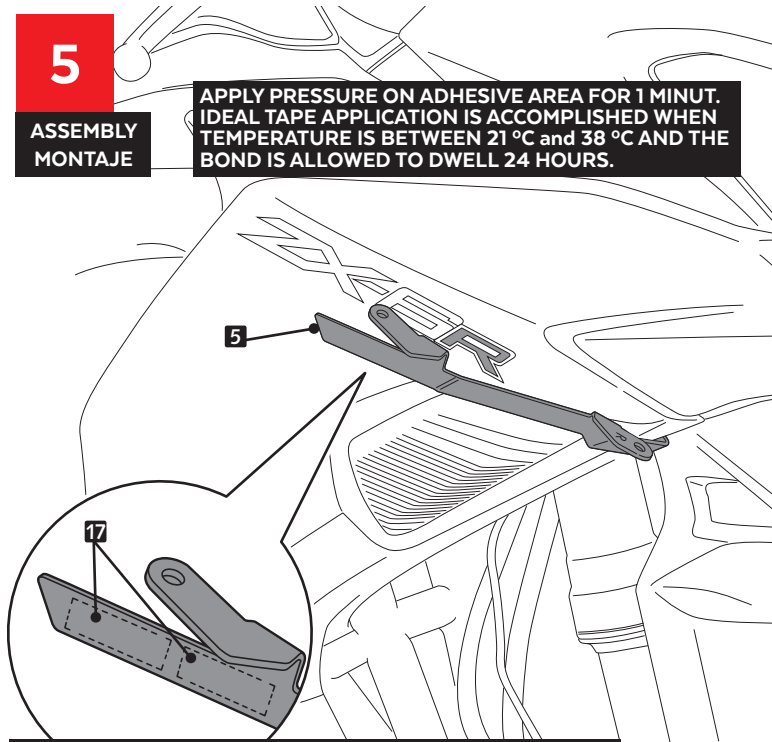

ID-17 Extraer papel de cinta adhesiva de doble cara.
Extract the paper from the double-sided adhesive tape.

6

ASSEMBLY
MONTAJE

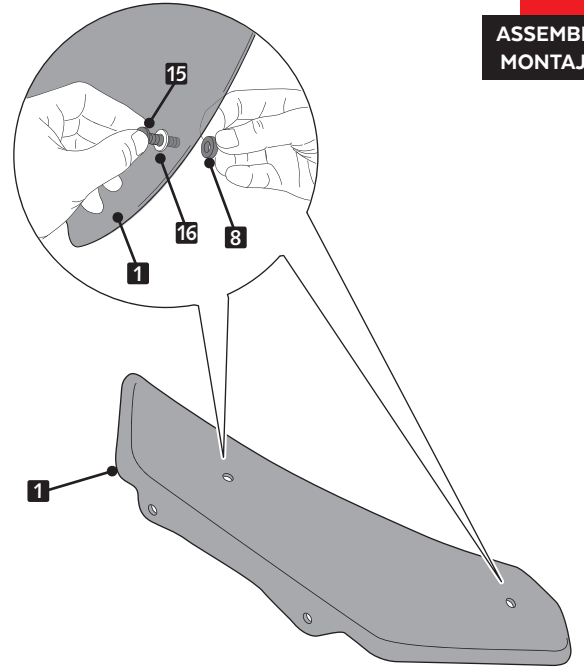

7

ASSEMBLY
MONTAJE

