

KTM 790 ADVENTURE '19- / R '19- / 890 ADVENTURE '21-

M O U N T I N G I N S T R U C T I O N S

REF 20504

M.E.M. (MANUAL ELEVATION MECHANISM) FOR SCREENS

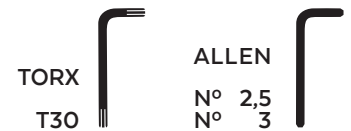

ID	PIEZA/PART	DESCRIPCIÓN	DESCRIPTION	QTY	REF
1		Guías	Guides	2	VARILLMEM-20504
2		Soporte cúpula izquierdo	Left screen support	1	SOP12P11SL20504
3		Soporte cúpula derecho	Right screen support	1	SOP12P11SR20504
4		Soporte inferior	Lower support	1	SOP12P11-L20504
5		Soporte central	Central support	1	SOP12P11-C20504
6		Soporte varilla izquierdo	Left guide support	1	SOP12P11GL20504
7		Soporte varilla derecho	Right guide support	1	SOP12P11GR20504
8		Soporte palanca izquierdo	Left lever support	1	SOP12P11LL20504
9		Soporte palanca derecho	Right lever support	1	SOP12P11LR20504
10		Soporte unión palanca-cúpula izquierdo	Left screen-lever support	1	SO12P11LSL20504
11		Soporte unión palanca-cúpula derecho	Right screen-lever support	1	SO12P11LSR20504
12		Casquillo nylon superior (washer A)	Upper nylon bush (washer A)	2	CASQUI-----851
13		Casquillo nylon inferior (washer B)	Lower nylon bush (washer B)	2	CASQUI-----852
14		Casquillo Ø4,3x Ø8 x2,5	Ø4,3x Ø8 x2,5 spacer	2	CASQUI-----3732
15		Tornillo Allen M4x12 Ø9 ISO7380	M4x12 Ø9 ISO7380 Allen screw	2	TORNI-I7380-800
16		Tornillo Allen M4x10 DIN912	M4x10 DIN912 screw	8	TORNI-I7380-645
17		Tuerca M4 autoblocante	M4 nut	2	TUERCAE985-0290
18		Tapón tuerca M4	M4 nut cap	2	TAPON-----91
19		Arandela Grower M4 DIN127/B	M4 DIN127/B Grower washer	8	ARAND-----854
20		Tornillo Allen M5x16 Ø11 ISO 7380	M5x16 Ø11 ISO 7380 Allen screw	2	TORNI-I7380-493
21		Tornillo Allen M5x30 Ø11 ISO 7380	M5x30 Ø11 ISO 7380 Allen screw	1	TORNI-I7380-767
22		Arandela de Nylon M5x1	M5x1 nylon washer	1	ARNV0000000245
23		Tornillo M3x10 ISO7380 (Negro)	M3x10 ISO7380 Screw (Black)	2	TORNI-I7380-904
24		Tuerca M3 DIN985	M3 DIN 985 Nut	2	TUERCA-D985-883

KTM 790 ADVENTURE '19- / R '19- / 890 ADVENTURE '21-

INSTRUCCIONES DE MONTAJE - MOUNTING INSTRUCTIONS - MONTAGEANLEITUNG

1

DISASSEMBLY
DESMONTAJE

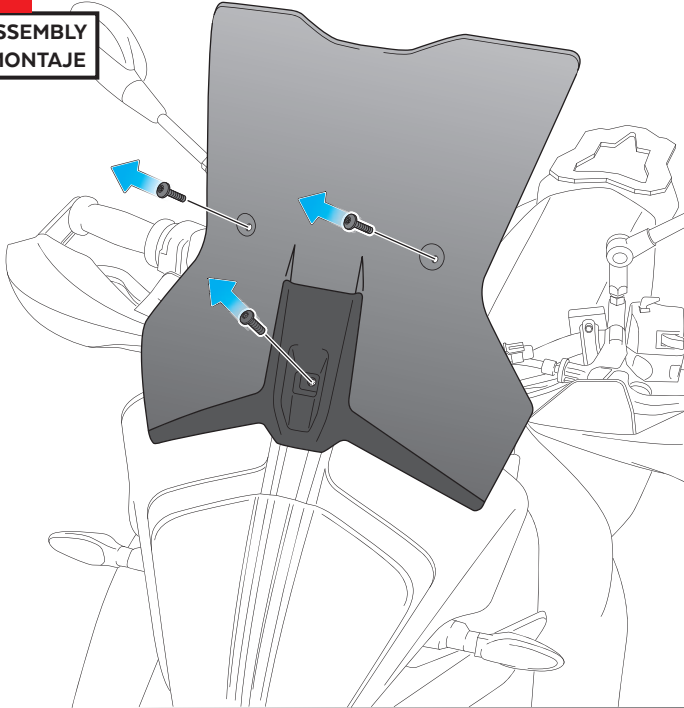

2

DISASSEMBLY
DESMONTAJE

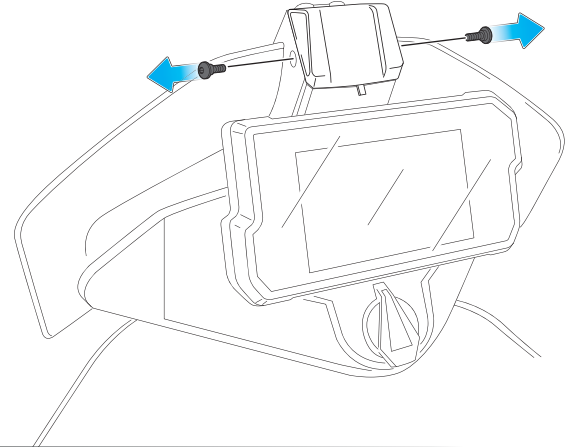

3

ASSEMBLY
MONTAJE

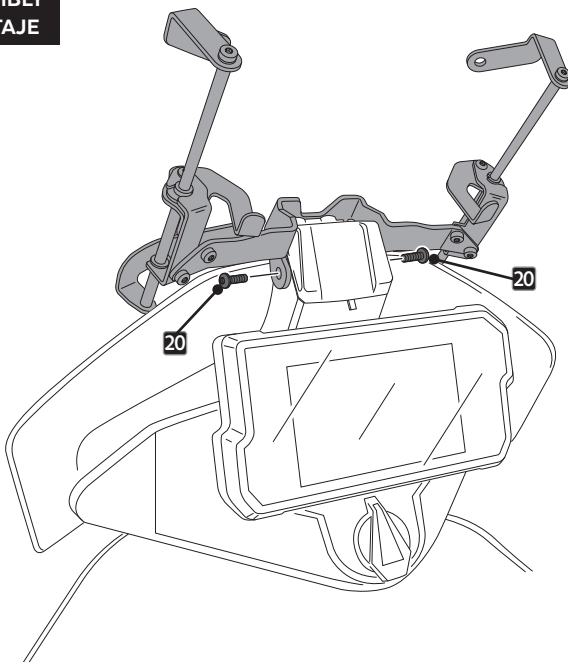

4

ASSEMBLY
MONTAJE

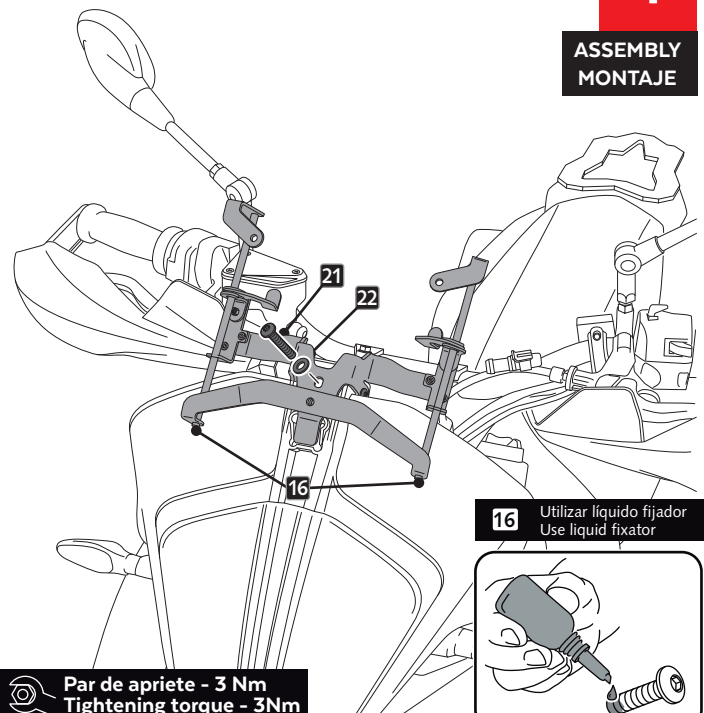

16 Par de apriete - 3 Nm
Tightening torque - 3Nm

16 Utilizar liquido fijador
Use liquid fixator

KTM 790 ADVENTURE '19- / R '19- / 890 ADVENTURE '21-

INSTRUCCIONES DE MONTAJE - MOUNTING INSTRUCTIONS - MONTAGEANLEITUNG

5

ASSEMBLY
MONTAJE

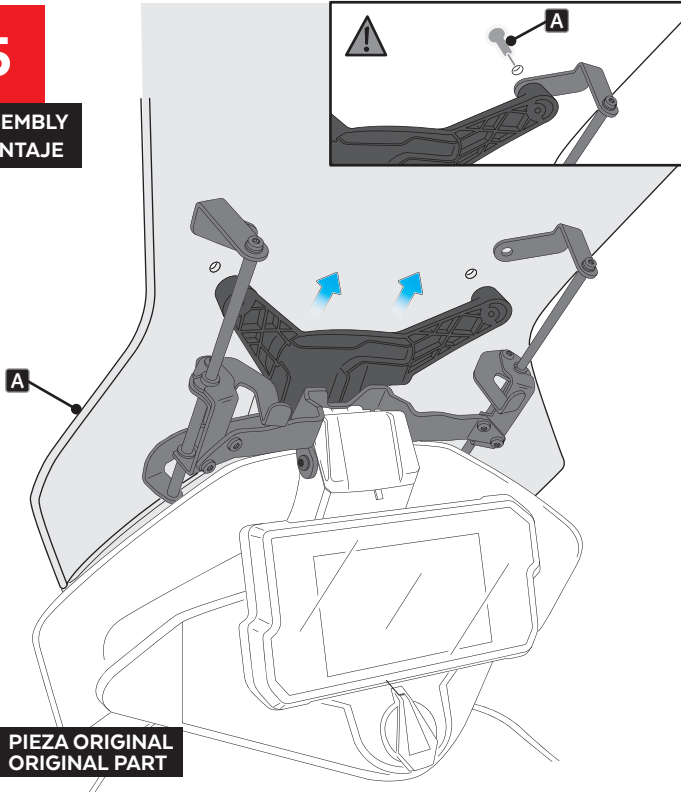
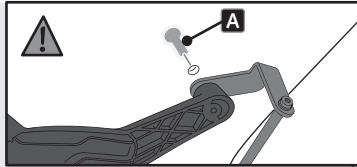

A PIEZA ORIGINAL
ORIGINAL PART

6

ASSEMBLY
MONTAJE

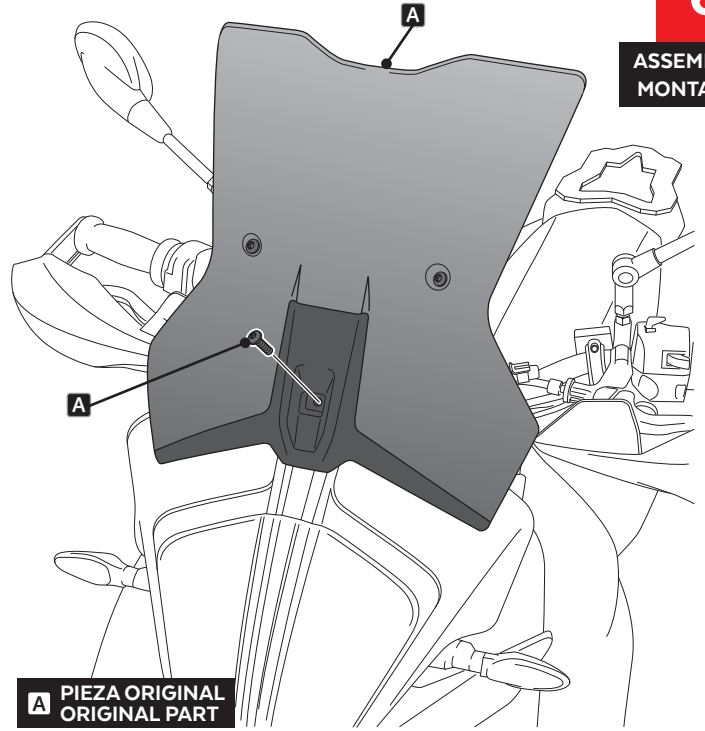

A PIEZA ORIGINAL
ORIGINAL PART

7

COMPROBAR EL CORRECTO FUNCIONAMIENTO
CHECK THE CORRECT OPERATION

ASSEMBLY
MONTAJE

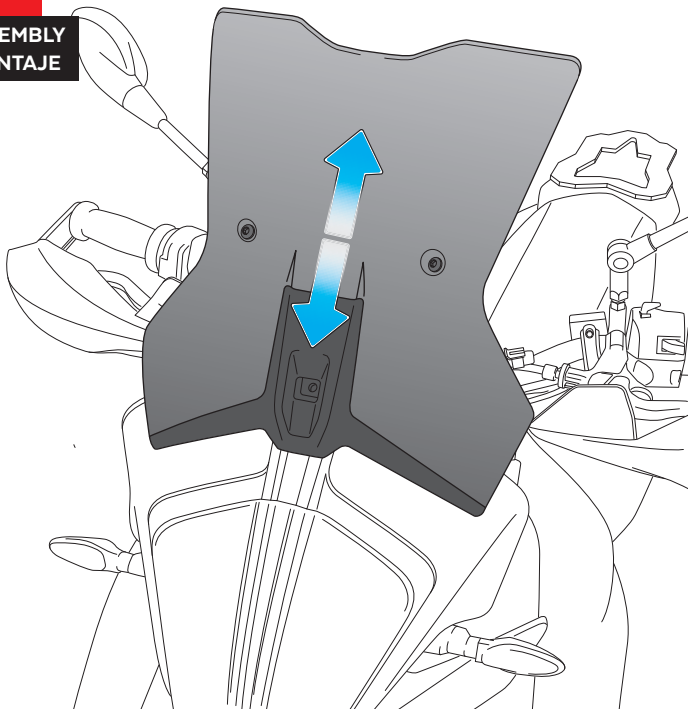

SI ES NECESARIO AJUSTAR LA POSICIÓN DE LOS SOPORTES ID2/ID3 O ID5/ID6
IF IT IS NECESSARY, ADJUST THE POSITION OF SUPORTS ID2/ID3 OR ID6/ID6

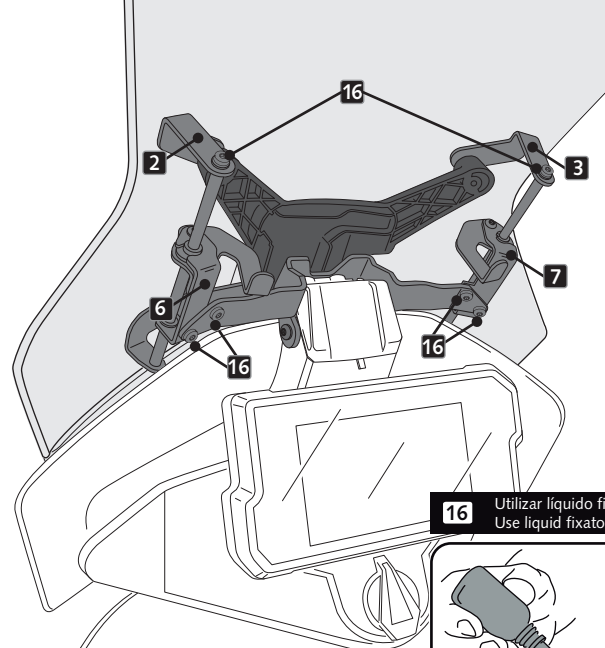

16 Utilizar líquido fijador
Use liquid fixator

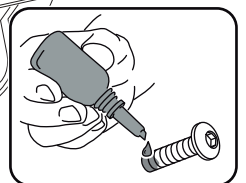

16 Par de apriete - 3 Nm
Tightening torque - 3Nm

KTM 790 ADVENTURE '19- / R '19- / 890 ADVENTURE '21-

EXPLOTING

