

# KAWASAKI Z900 '17-'19

## M O U N T I N G I N S T R U C T I O N S

REF 20327

NAKED SPOILERS

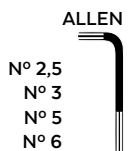
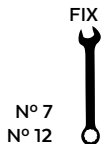

ID.	PIEZA/PART	DESCRIPCIÓN	DESCRIPTION	QTY.	REF.:
1		Tapa derecha	Right cover	1	10770JM3
2		Deflector derecho	Right deflector	1	20329N/VM3
3		Tapa Izquierda	Left cover	1	10770JM3
4		Deflector izquierdo	Left deflector	1	20329N/VM3
5		Soporte derecho R1	Right support R1	1	SOPOR6P2R120237
6		Soporte derecho R2	Right support R2	1	SOPOR6P2R220237
7		Soporte derecho R3	Right support R3	1	SOPOR6P2R320237
8		Soporte izquierdo L1	Left support L1	1	SOPOR6P2L120237
9		Soporte izquierdo L2	Left support L2	1	SOPOR6P2L220237
10		Soporte izquierdo L3	Left support L3	1	SOPOR6P2L320237
11		Arandela de nylon M4x0,5	M4x0,5 nylon washer	4	ARNV00000000311
12		Tornillo M4x16 ISO 7380	M4x16 ISO 7380 screw	4	TORNIAI7380-310
13		Silentblock M4	M4 silentblock	4	SILENBTM4---062
14		Tuerca de clip M5	M5 clip nut	2	TUERCA-TRT-M5--
15		Tornillo allen M5x16 Ø11 ISO 7380	M5x16 Ø11 ISO 7380 allen screw	8	TORNI-I7380-493
16		Tornillo M8x25 DIN 912	M8x25 DIN 912 screw	1	TORNI-D912--241
17		Tuerca Autoblocante M8	M8 Lock Nut	1	TUEA-D985.8-M8-
18		Tornillo allen M8x20 DIN 912	M8x20 DIN 912 screw	2	TORNI-D912--164
19		Tapón tornillo M5 ISO 7380	M5 ISO 7380 allen screw cap	6	TAPON-----85
20		Silentblock Ø9 xØ6 x8mm	Ø9 xØ6 x8mm silentblock	6	AROPASACABLES-3
21		Casquillo con valona Ø12xØ6,8x7,3	Ø12xØ6,8x7,3 bush with flange	6	CASQUI-1A---750

# KAWASAKI Z900 '17-'19

INSTRUCCIONES DE MONTAJE - MOUNTING INSTRUCTIONS - MONTAGEANLEITUNG

**1**

LADO IZQUIERDO - LEFT SIDE - LINKE SEITE

DISASSEMBLY  
DESMONTAJE

**A** Componentes originales  
Original components

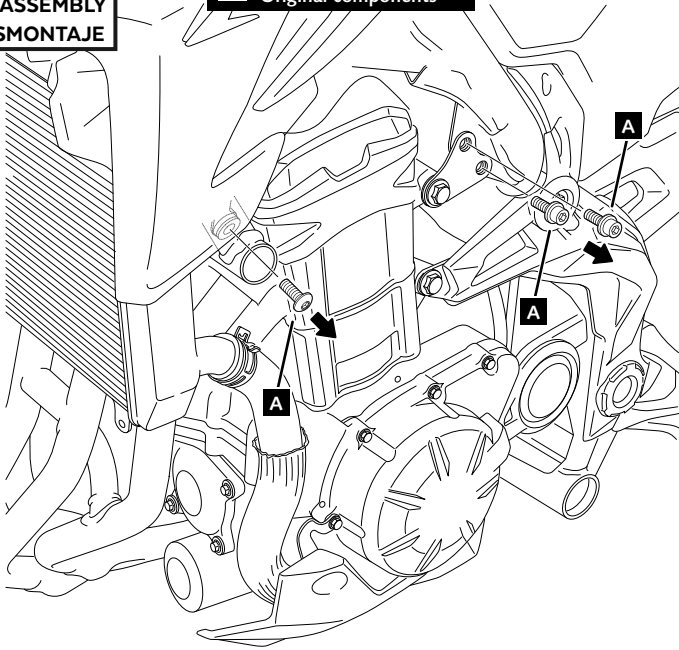

**2**

ASSEMBLY  
MONTAJE

**A** Componentes originales  
Original components

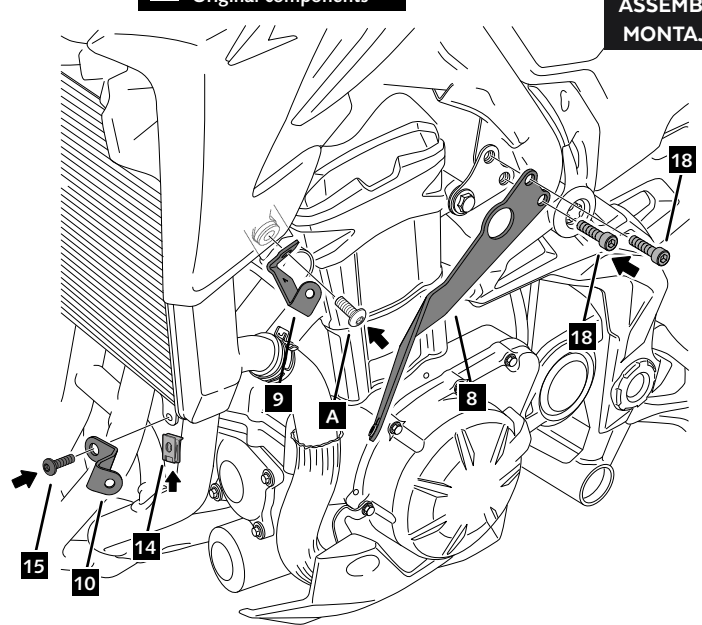

**3**

ASSEMBLY  
MONTAJE

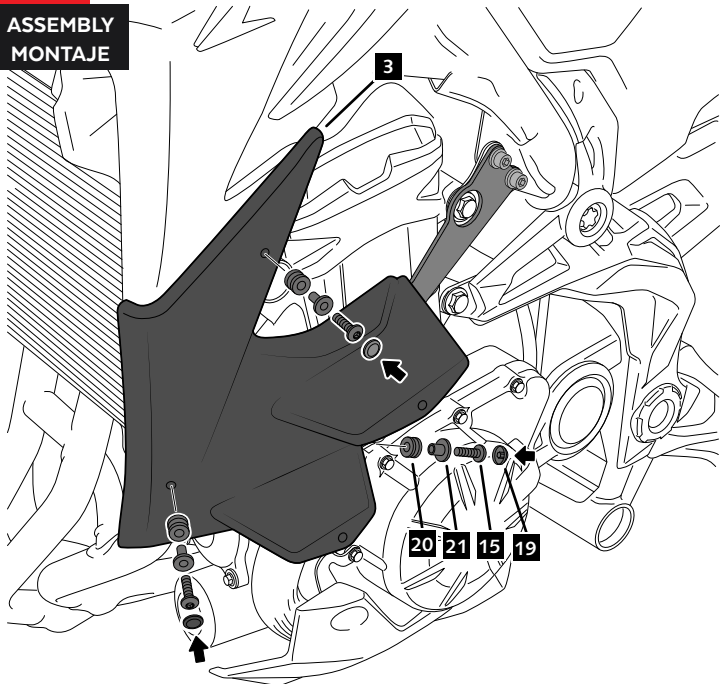

**4**

ASSEMBLY  
MONTAJE

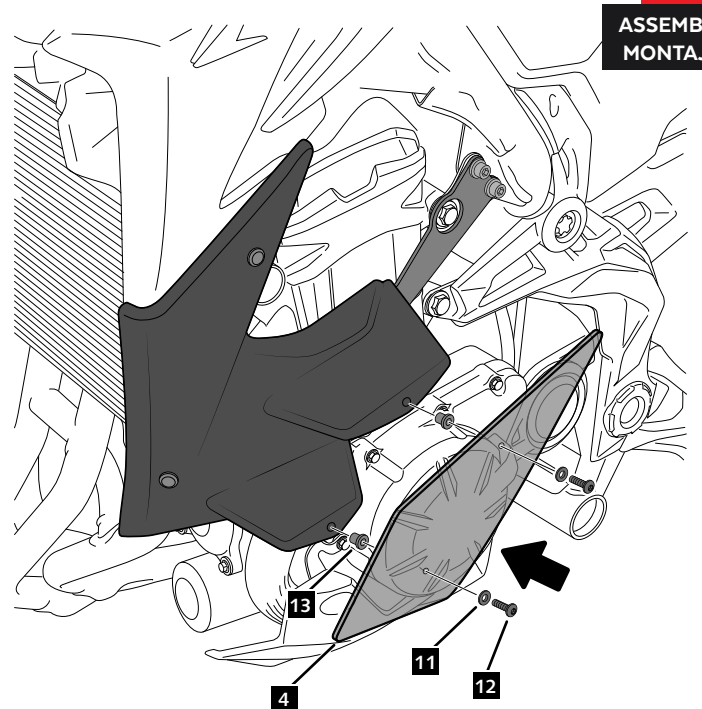

# KAWASAKI Z900 '17-'19

## INSTRUCCIONES DE MONTAJE - MOUNTING INSTRUCTIONS - MONTAGEANLEITUNG

**5**

LADO DERECHO - RIGHT SIDE - RECHTE SEITE

**DISASSEMBLY**  
**DESMONTAJE**

**A** Componentes originales  
Original components

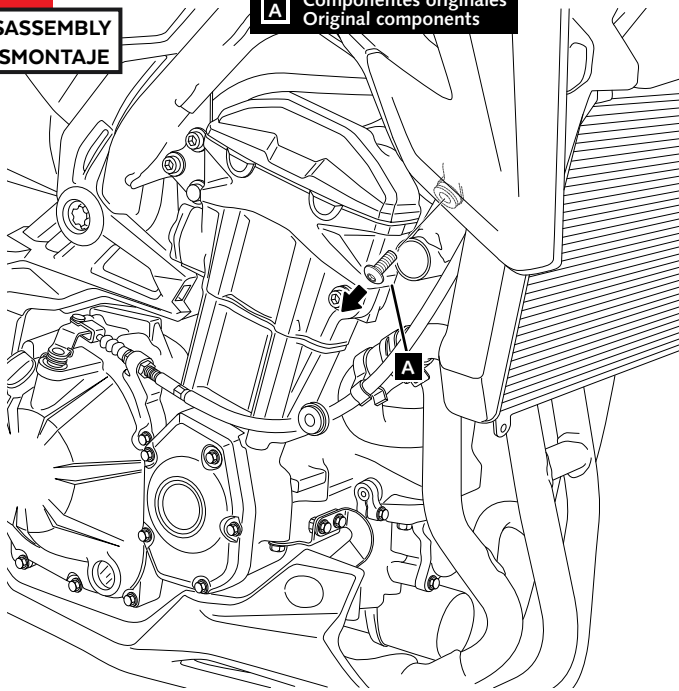

**6**

**ASSEMBLY**  
**MONTAJE**

**A** Componentes originales  
Original components

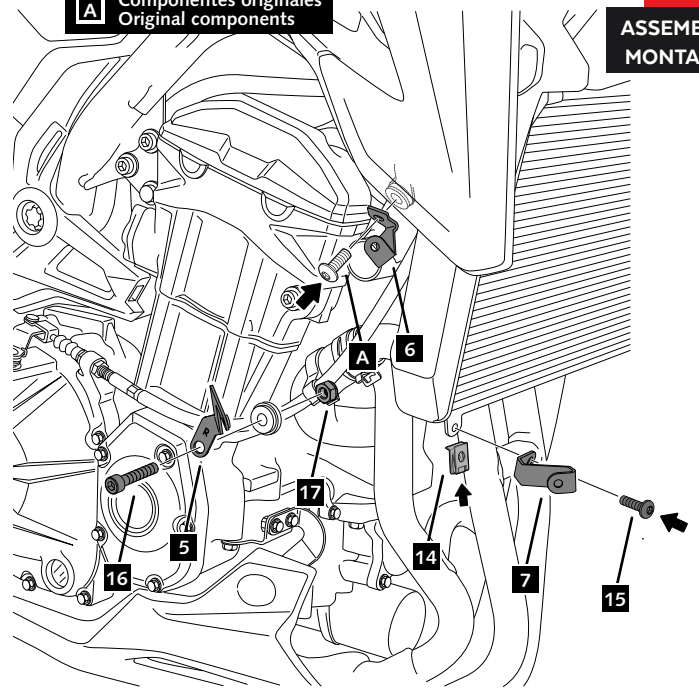

**7**

**ASSEMBLY**  
**MONTAJE**

**1**

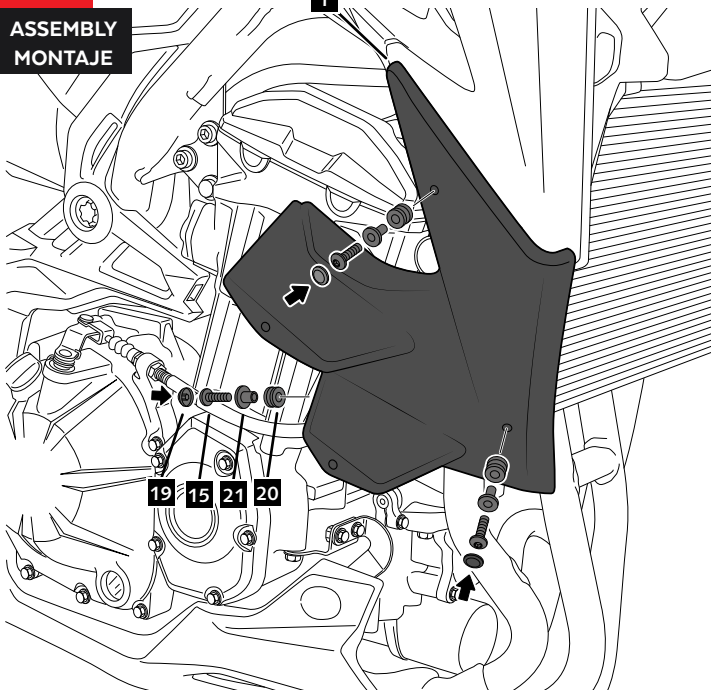

**8**

**ASSEMBLY**  
**MONTAJE**

