

TRIUMPH TIGER 900 / GT / GT PRO / GT LOW / RALLY / RALLY PRO '20-
TIGER 850 SPORT '21-

M O U N T I N G I N S T R U C T I O N S

REF 20377

HEADLIGHT PROTECTOR



TORX
T30



ALLEN
Nº 2,5
Nº 4



ID	PIEZA/PART	DESCRIPCIÓN	DESCRIPTION	QTY	REF
1		Protector de faro	Headlight protector	1	20377M3
2		Soporte metálico derecho (R)	Right metal support	1	SOPOR2P2-R20377
3		Soporte metálico izquierdo (L)	Left metal support	1	SOPOR2P2-L20377
4		Casquillo Ø8,5x Ø 14x 15	Ø8,5x Ø 14x 15 Arrowhead	2	CASQUI81415-101
5		Tornillo Allen M6x25 Ø14 ISO 7380	M6x25 Ø14 ISO 7380 Allen screw	2	TORNI-I7380-405
6		Tornillo Allen M4x12 Ø9 ISO 7380	M4x12 Ø9 ISO 7380 Allen screw	4	TORNI-I7380-800
7		Casquillo con valona Ø12x Ø6,8 x 7,3	Ø12x Ø6,8 x 7,3 bush with flange	4	CASQUI-1A---750
8		Silentblock Ø9 xØ6 x8mm	Ø9 xØ6 x8mm Silentblock	4	AROPASACABLES-3
9		Junta tórica 3x2	3x2 O-ring	4	JUNTATORICA-3X2

TRIUMPH TIGER 900 / GT / GT PRO / GT LOW / RALLY / RALLY PRO '20-
TIGER 850 SPORT '21-

INSTRUCCIONES DE MONTAJE - MOUNTING INSTRUCTIONS - MONTAGEANLEITUNG

1

DISASSEMBLY
DESMONTAJE

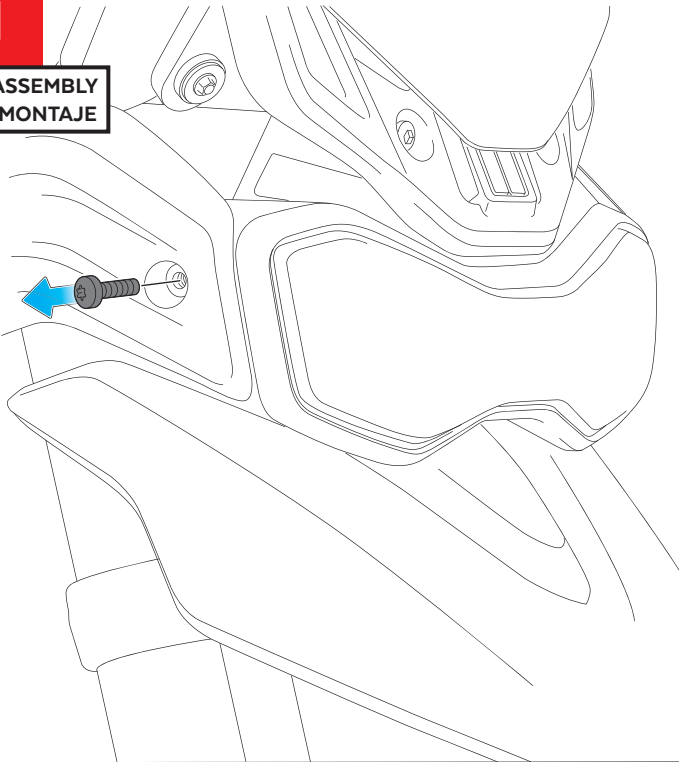

2

DISASSEMBLY
DESMONTAJE

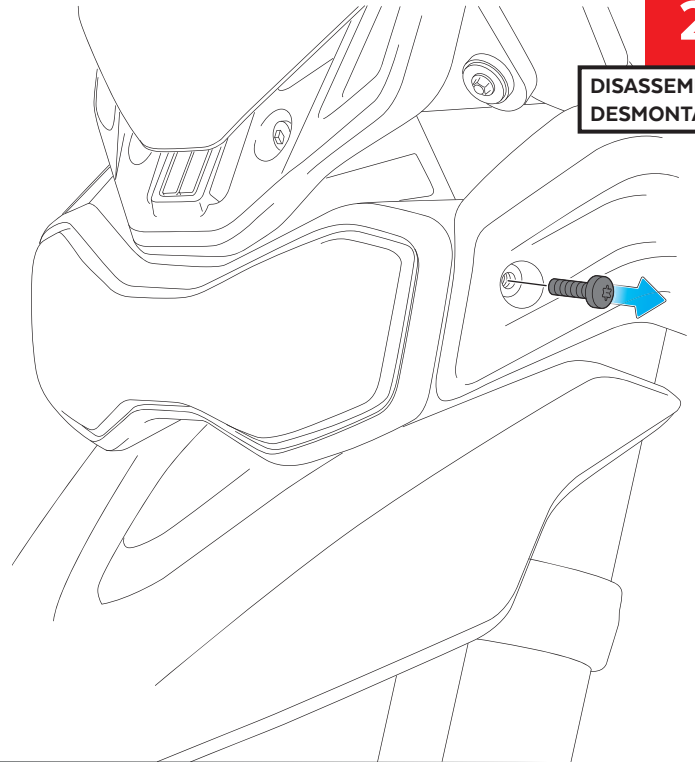

3

ASSEMBLY
MONTAJE

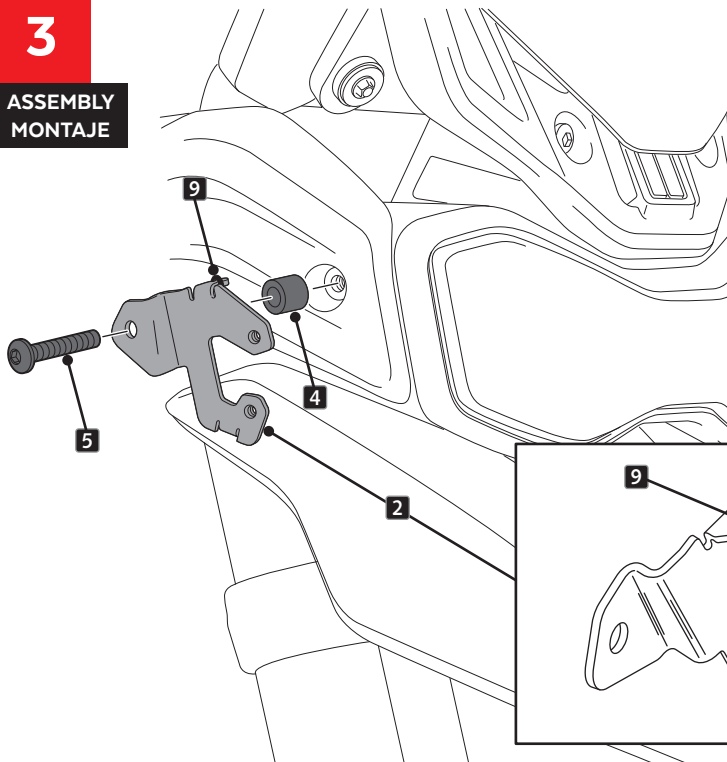

4

ASSEMBLY
MONTAJE

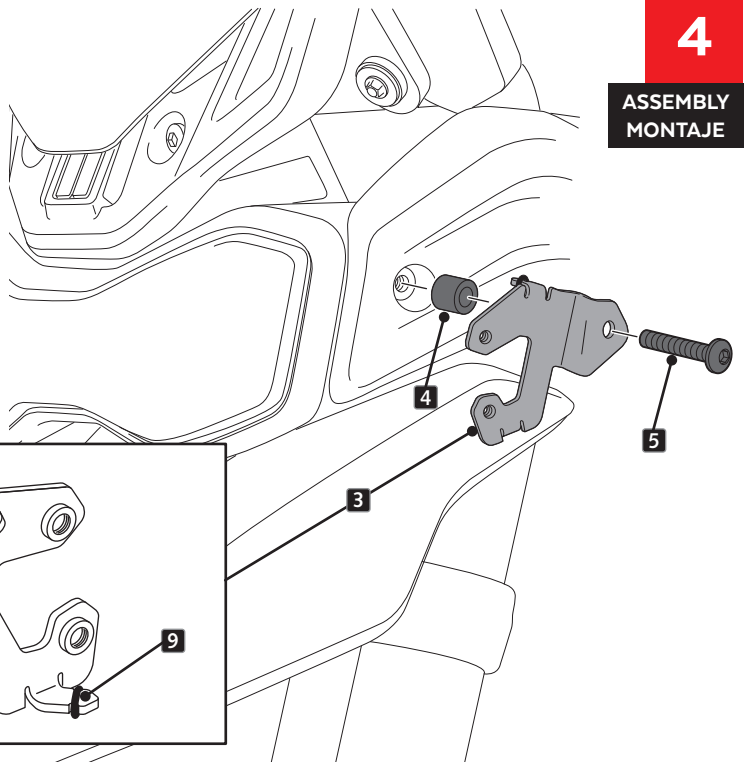

TRIUMPH TIGER 900 / GT / GT PRO / GT LOW / RALLY / RALLY PRO '20-
TIGER 850 SPORT '21-

INSTRUCCIONES DE MONTAJE - MOUNTING INSTRUCTIONS - MONTAGEANLEITUNG

5

ASSEMBLY
MONTAJE

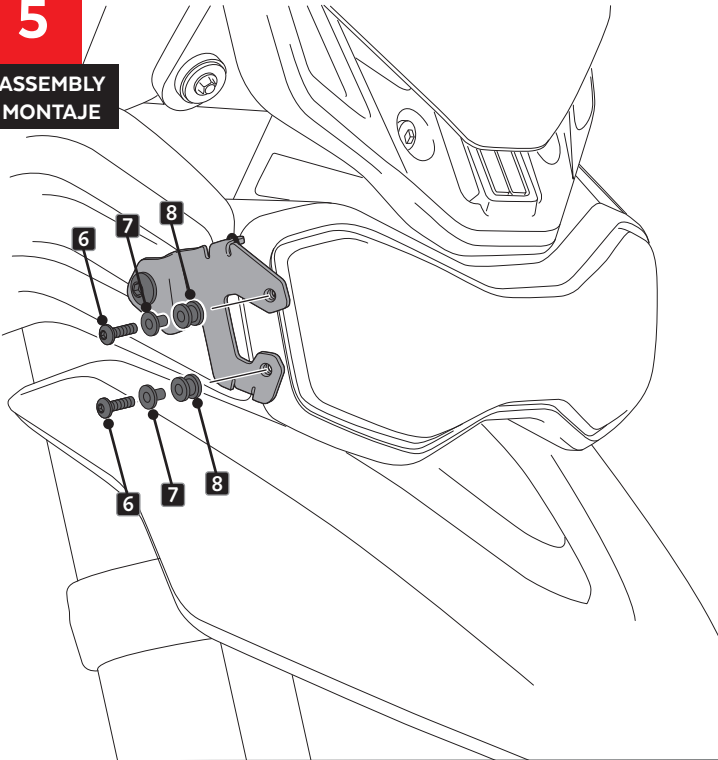

6

ASSEMBLY
MONTAJE

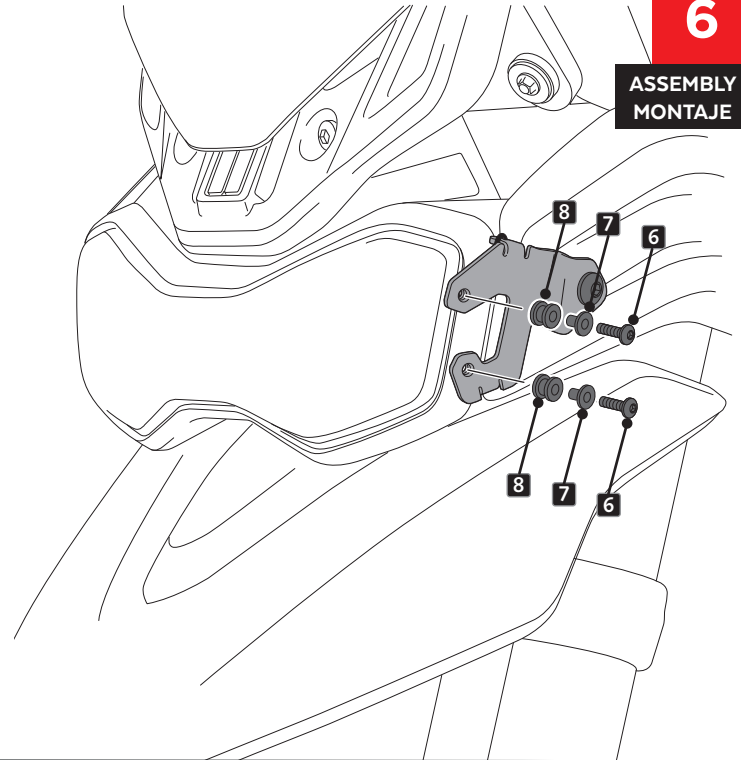

7

ASSEMBLY
MONTAJE

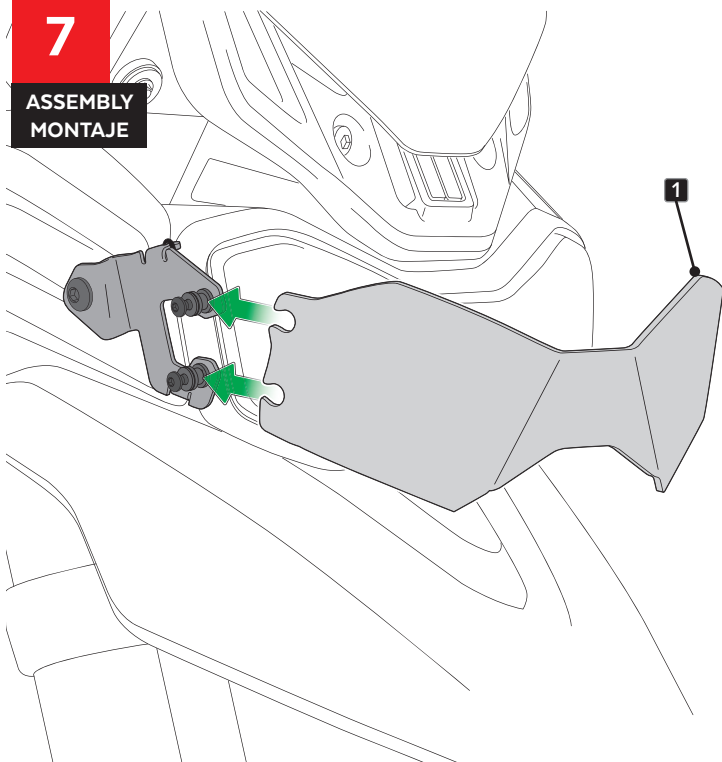

8

ASSEMBLY
MONTAJE

