

HONDA CB500 HORNET '24-

M O U N T I N G I N S T R U C T I O N S

REF 21936

DOWNFORCE NAKED FRONTAL SPOILER



1 Person



20 min



EASY



ALLEN



Nº 3
Nº 5

ID.	PIEZA/PART	DESCRIPCIÓN	DESCRIPTION	QTY.	REF.:
1		Alerón Frontal Naked	Naked Frontal Spoiler	1	21936N/JM3
2		Soporte	Support	1	SOPORIP1--21936
3		Silentblock Ø18x Ø9 xØ11 x8	Ø18x Ø9 xØ11 x8 silentblock	2	SILENBGONE--064
4		Casquillo con valona Ø15 xØ9 x7,5	Ø15 xØ9 x7,5 Bush with flange	2	CASQUI-1A---324
5		Casquillo Ø8,5xØ13x15mm	Ø8,5xØ13x15mm arrowhead	2	CASQUI-M----614
6		Tornillo allen M6x40 ISO7380	M6x40 ISO7380 allen screw	2	TORNI-I7380-538
7		Tope de goma Ø3,7-3,8 x 3,2mm	Ø3,7-3,8 x 3,2mm bumper foot	2	TOPE--POF-40022
8		Arandela de goma Ø4,5 x Ø11 x 2mm	Ø4,5 x Ø11 x 2mm rubber washer	2	ARAND-EPDM--722
9		Tornillo M5x12 DIN7991	M5x12 DIN7991 allen screw	2	TORNI-D7991-611
10		Tapón tornillo M5 DIN7991	M5 DIN7991 screw Cap	2	TAPON-----92

HONDA CB500 HORNET '24-

INSTRUCCIONES DE MONTAJE - MOUNTING INSTRUCTIONS - MONTAGEANLEITUNG

1

**DISASSEMBLY
DESMONTAJE**

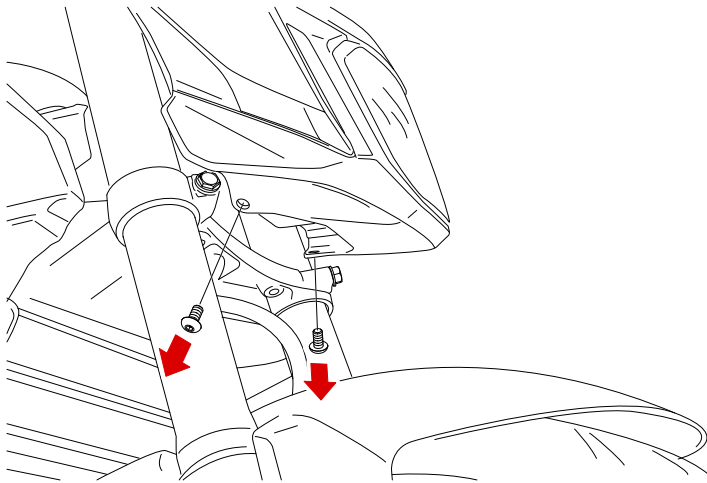

2

**ASSEMBLY
MONTAJE**

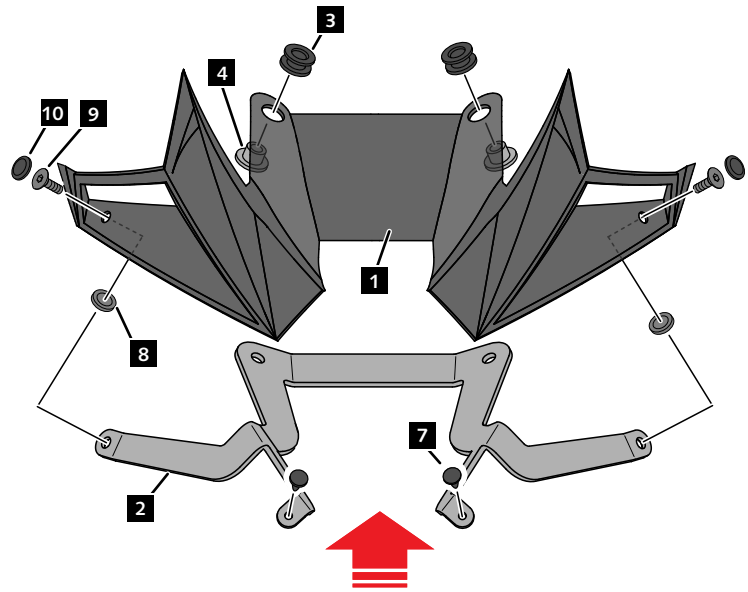

3

**ASSEMBLY
MONTAJE**

